



Lockouts

Designed to enable Battery Master Switches to be securely locked.

Different colours and styles of lockout brackets are available for a selection of Battery Master Switches.



Remote Switching

Remote Switching (page 39) Battery Master Switches are switched electrically rather than manually, allowing them to be integrated anywhere within a vehicles system. These switches can be triggered remotely from anywhere on the vehicle.

Rated to IP65 and housed in robust polymer allows safe mounting internally or externally.

12V & 24V models are available in single and double pole.



Double Pole

Double Pole Battery Master Switches can control two independent circuits or be used to isolate both positive and or negative simultaneously.

Double Pole units are available in both the manual and remote switching ranges.



Battery Master Switches

| | |
|------------------------|----|
| Fixed Handle | 28 |
| L Handle | 31 |
| Removable Key | 34 |
| T Handle | 35 |
| General | 36 |
| Remote Switching | 39 |
| Marine Series | 37 |
| Big Red | 38 |
| Battery Lockout Kits | 40 |
| Universal Lockout Kits | 42 |
| BMS – Accessories | 44 |

BMS - Manual Switching

Fixed Handle



- Silver alloy contacts on most models.
- Weather resistant.
- Most switches able to be locked with optional lockout bracket where available.
- Integrated lockout with 75920 series and BMS-001 & BMS-002.
- 75920, BMS-001 & BMS-002 environmentally sealed – IP67.
- Auxiliary contacts on selected models.
- 75912B Double Pole model.

6V
36V

Voltage : 6-36V
Contacts : Silver Alloy
Ingress Protection : 75903 Copper
 BMS-20 IP53
 BMS-001 & BMS-002, 75920 Series IP67

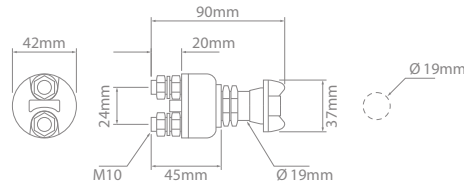
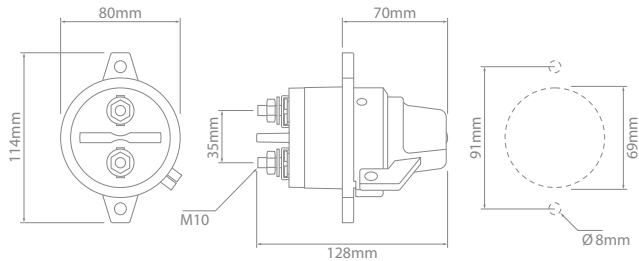
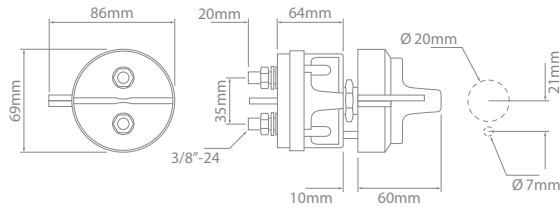

Fixed Handle – Polymer

| Part No. | Description | Main Contacts (A) | | Fits Panel Thickness (mm) |
|--|-----------------------------|-------------------|------------|---------------------------|
| | | Intermittent | Continuous | |
| 75920 | Single Pole – Red handle | 3000 | 300 | 12 |
| 75920-01B | Single Pole – Yellow handle | 3000 | 300 | 12 |
| BMS-001 NEW | Single Pole – Red handle | 2000 | 250 | — |
| BMS-002 NEW | Single Pole – Yellow handle | 2000 | 250 | — |
| BMS-20 | Single Pole | 1000 | 125 | 8.8 |

BMS - Manual Switching

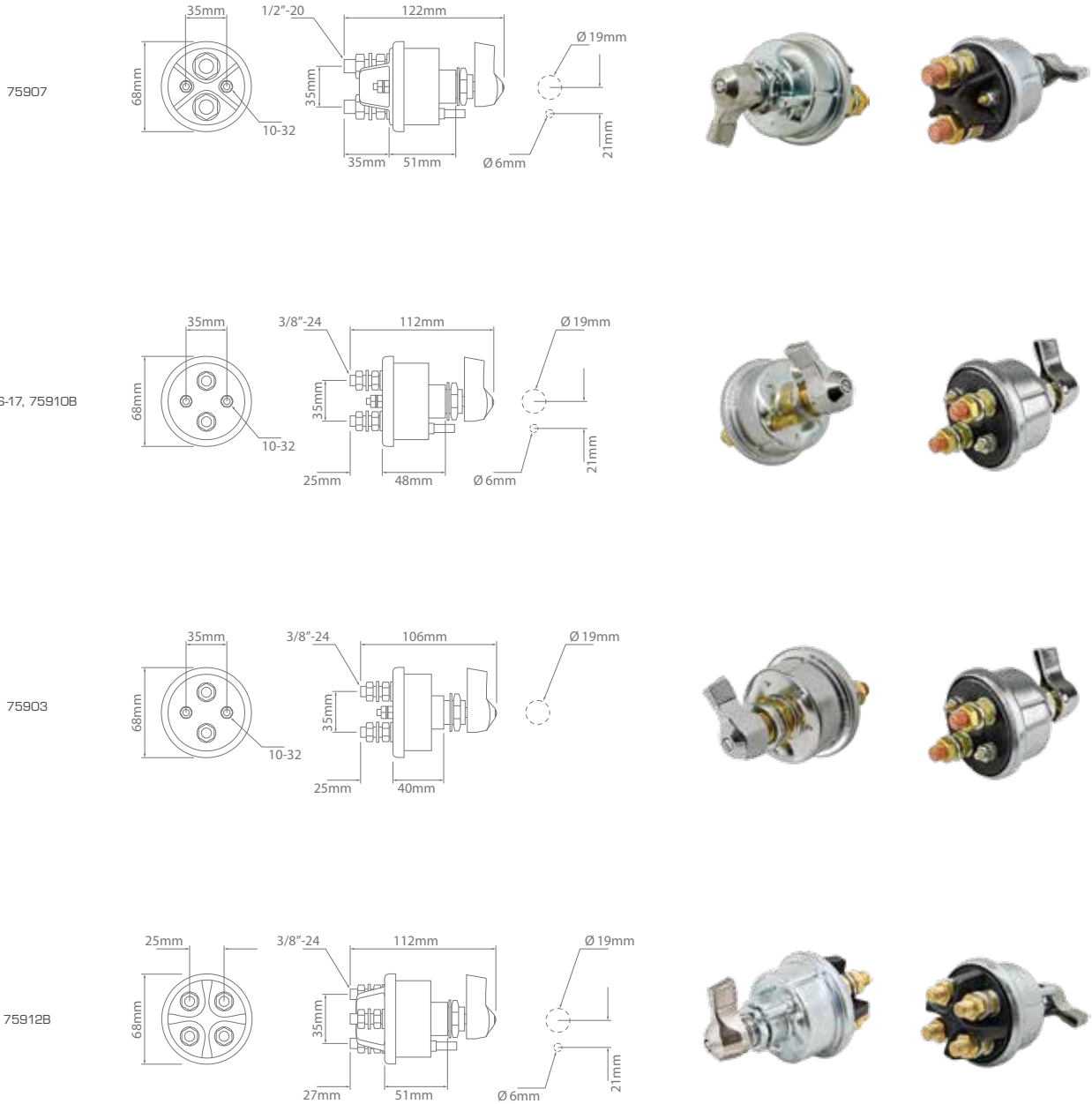

Fixed Handle – Metal

| Part No. | Description | Main Contacts (A) | | Auxiliary Contacts (A) | Fits Panel Thickness (mm) |
|---------------|----------------------------|-------------------|------------|------------------------|---------------------------|
| | | Intermittent | Continuous | Continuous | |
| 75907 | Single Pole with Auxiliary | 2000 | 300 | 20 | 6.4 |
| BMS-17 | Single Pole with Auxiliary | 1000 | 300 | 20 | 6.4 |
| 75910B | Single Pole with Auxiliary | 1000 | 125 | 20 | 6.4 |
| 75903 | Single Pole with Auxiliary | 1000 | 125 | 20 | 4.8 |
| 75912B | Double Pole | 750 | 125 | — | 6.5 |



BMS - Manual Switching



BMS-001BKT



BMS-18



BMS-18R



BMS-18Y



LS11004-01



LS11004-02



Padlock not supplied with lockout brackets



BMS-3R



BMS-3Y



Padlock not supplied with lockout brackets



BMS-ES, BMS-IMP

Fixed Handle - Accessories

| Part No. | Description | Suits |
|--|--|--|
| BMS-001BKT NEW | Mounting bracket - powder coated Black | BMS-001, BMS-002 |
| BMS-18 | Lockout - 2 piece metal | 75907, BMS-17, 75910B, 75903, 75912B |
| BMS-18R | Lockout - 2 piece metal - powder coated Red | 75907, BMS-17, 75910B, 75903, 75912B |
| BMS-18Y | Lockout - 2 piece metal - powder coated Yellow | 75907, BMS-17, 75910B, 75903, 75912B |
| LS11004-01 | Lockout - Hinged stainless steel - powder coated Red | 75907, BMS-17, 75910B, 75903, 75912B |
| LS11004-02 | Lockout - Hinged stainless steel - powder coated Yellow | 75907, BMS-17, 75910B, 75903, 75912B |
| BMS-3R | Lockout - 2 piece nylon - Red | BMS-20 |
| BMS-3Y | Lockout - 2 piece nylon - Yellow | BMS-20 |
| BMS-ES | 60mm Brass extension stud - M10 | BMS-001, BMS-002, BMS-20 |
| BMS-IMP NEW | 60mm Brass extension stud - 3/8"-24 | 75920, 75920-01B, BMS-17, 75910B, 75903, 75912B |

BMS - Manual Switching

L Handle

- BMS-05L & BMS-12L feature an integrated locking facility.
- BMS-05/L & BMS-12/L environmentally sealed – IP66.
- Single and double pole models.
- Lockout brackets available for BMS-05 & BMS-12.
- BMS-12/L features silver plated contacts.
- BMS-ES extension stud available. See BMS Accessories – page 33.
- Weather resistant.



| | |
|-----------------------------|-------------------------------|
| Voltage : | 6-36V |
| Contacts : | Copper |
| | BMS-12/L Silver plated Copper |
| | Zinc plated |
| Handle : | Zinc plated |
| Body : | BMS-07 Bakelite |
| | BMS-05/L, BMS-12/L Bakelite |
| Ingress Protection : | BMS-07 IP43 |
| | BMS-05/L, BMS-12/L IP66 |

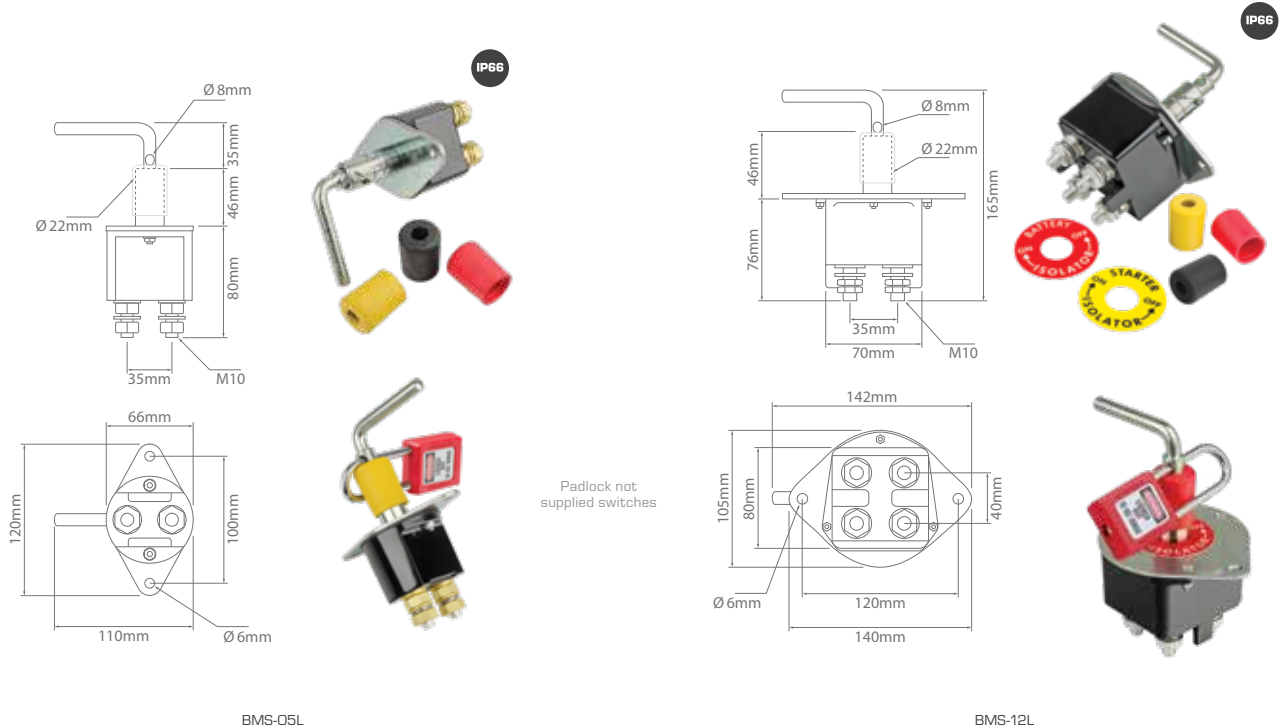

L Handle – Lockable

| Part No. | Description | Contacts (A) | |
|----------------|---|--------------|------------|
| | | Intermittent | Continuous |
| BMS-05L | Single Pole | 2500 | 250 |
| BMS-12L | Double Pole. Supplied with Starter & Battery decals | 2500 | 250 |



BMS - Manual Switching



IP43

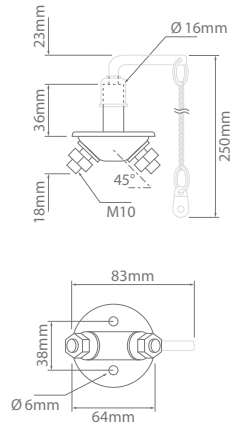

BMS-07



IP66

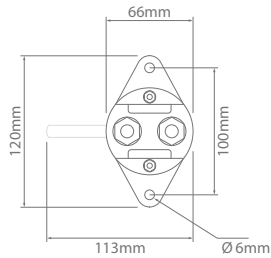
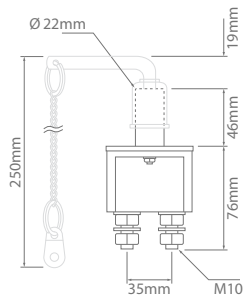

BMS-05



IP66

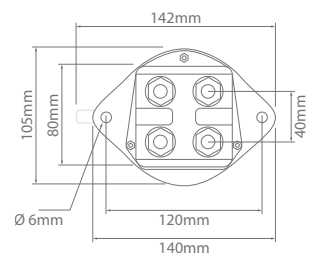
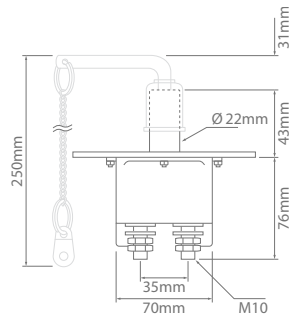

BMS-12

L Handle - Removable

| Part No. | Description | Contacts (A) | |
|----------|---|--------------|------------|
| | | Intermittent | Continuous |
| BMS-07 | Single Pole | 500 | 100 |
| BMS-05 | Single Pole. Supplied with Starter & Battery decals | 2500 | 250 |
| BMS-12 | Double Pole. Supplied with Starter & Battery decals | 2500 | 250 |

BMS - Manual Switching



L Handle – Accessories

| Part No. | Description | Suits |
|--|---|------------------------|
| BMS-2R | Metal lockout bracket for use with a padlock. Powder coated Red | BMS-05 |
| BMS-2Y | Metal lockout bracket for use with a padlock. Powder coated Yellow | BMS-05 |
| BMS-05K | Spare lever handle key with rubber boot and chain | BMS-05, BMS-12 |
| BMS-05BKT | Metal mounting bracket. Powder coated Black | BMS-05, BMS-05L |
| BMS-1R | Metal lockout bracket for use with a padlock. Powder coated Red | BMS-12 |
| BMS-1Y | Metal lockout bracket for use with a padlock. Powder coated Yellow | BMS-12 |
| LS11003-01 | Metal lockout bracket for use with a padlock – Stainless steel. Powder coated Red | BMS-05, BMS-12 |
| LS11003-02 | Metal lockout bracket for use with a padlock – Stainless steel. Powder coated Yellow | BMS-05, BMS-12 |
| BMS-4R NEW | Metal lockout bracket for use with a padlock. Powder coated Red | BMS-05, BMS-12 |
| BMS-4Y NEW | Metal lockout bracket for use with a padlock. Powder coated Yellow | BMS-05, BMS-12 |
| BMS-12K | Spare lever handle key with rubber boot | BMS-05, BMS-12 |
| BMS-12BKT | Metal mounting bracket. Powder coated Black | BMS-12, BMS-12L |
| BMS-ES | 60mm Brass extension stud – M10 | All L Handle |



BMS - Manual Switching

Removable Key

6V
36V



- Weather resistant.
- Removable keys.
- Silver alloy contacts.

Voltage :
Contacts :
Key :
Body :

6-36V
Silver Alloy
Zinc plated
Zinc plated

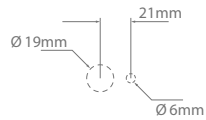

Mounting Dimensions

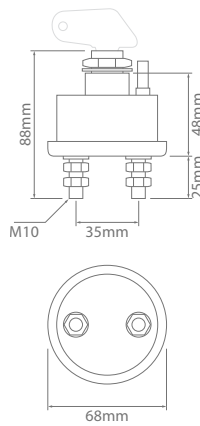

Removable Key

| Part No. | Description | Contacts (A) | | Fits Panel Thickness (mm) |
|----------|-------------|--------------|------------|---------------------------|
| | | Intermittent | Continuous | |
| BMS-10 | Single Pole | 1000 | 125 | 4.8 |

BMS - Manual Switching

- Fixed T handles.
- Marine model (BMS-15) with polyester coating.
- Environmentally sealed.
- BMS-09 silver alloy contacts.



T Handle

6V
36V

| | | |
|-----------------------------|--------|--------------|
| Voltage : | | 6-36V |
| Contacts : | BMS-09 | Silver Alloy |
| | BMS-15 | Copper |
| Handle : | BMS-09 | Die-cast |
| | BMS-15 | Polymer |
| Body : | | Bakelite |
| Ingress Protection : | BMS-09 | IP65 |
| | BMS-15 | IP64 |

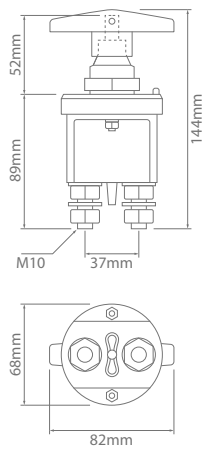
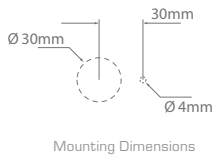

BMS-09



IP65

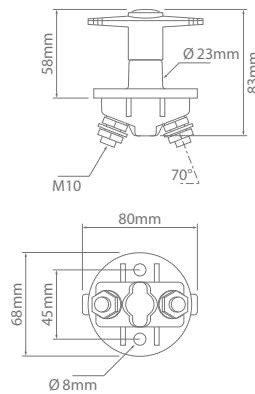

BMS-15



IP64

T Handle

| Part No. | Description | Contacts (A) | | Fits Panel Thickness (mm) |
|---------------|--------------------|--------------|------------|---------------------------|
| | | Intermittent | Continuous | |
| BMS-09 | Single Pole | 2500 | 250 | 11 |
| BMS-15 | Single Pole Marine | 1000 | 150 | — |



BMS - Manual Switching

General



- Removable key.
- Dust cover.
- Corrosion resistant construction.
- BMS-16 features auxiliary contacts.

12V
24V

Voltage : 12–24V
Contacts : Copper
Handle: Polymer PA6
Body : Polymer PA6
Ingress Protection : BMS-08 IP53
 BMS-06, BMS-16 IP43

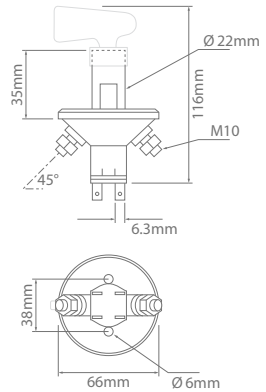
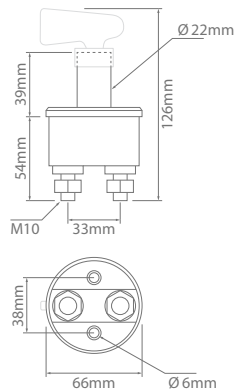
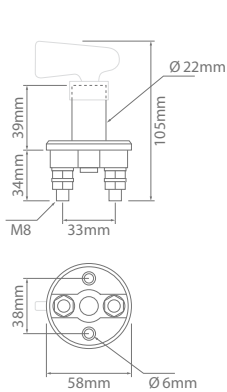

IP43



BMS-06

IP53



BMS-08

IP43



BMS-16

General

| Part No. | Description | Main Contacts (A) | | Auxiliary Contacts (A) |
|----------------|----------------------------|-------------------|------------|------------------------|
| | | Intermittent | Continuous | Continuous |
| BMS-06 | Single Pole | 500 | 100 | — |
| BMS-08 | Single Pole | 500 | 100 | — |
| BMS-16 | Single Pole with Auxiliary | 500 | 100 | 5 |
| BMS-06K | Replacement key | | | |

BMS-16 Auxiliary Contacts : NO & NC.

BMS - Manual Switching

- 2 & 4 position models.
- Removable panels for easy cable entry/access.
- BMS-21 features removable actuator.
- Single and dual battery applications.
- BMS-22 allows for switching between two batteries without power interruption.

NEW



BMS-22



BMS-21

Voltage :
Contacts :
Handle:
Body :

12-24V
Tinned Copper
PBT
Thermoplastic



BMS-21 features removable actuator



BMS-21

BMS-22

Removable panels

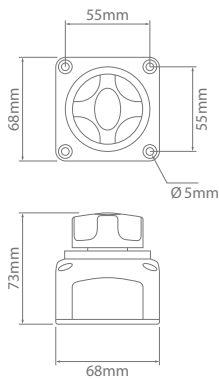

BMS-21



BMS-22

Marine Series **NEW**

| Part No. | Positions | Current Rating (A) | | Terminals |
|---------------|-------------------|--------------------|------------|----------------|
| | | Intermittent | Continuous | |
| BMS-21 | Off - On | 1000 | 200 | 2 x 10mm Studs |
| BMS-22 | Off - 1 - 1+2 - 2 | 1000 | 100 + 100 | 3 x 8mm Studs |



BMS - Remote / Manual Switching

Big Red



- Fully sealed, heavy duty, double pole.
- Designed for commercial, marine and industrial applications, specifically those carrying flammable loads.
- Anti-crack outer case material.
- Highly resistant to impact, fuel oils, petroleum etc.
- Self extinguishing during fire.
- Manual and remote switching capabilities.
- LED display indicates switched position.
- Environmentally sealed – IP66.
- 2 year warranty.

Contacts : Silver Alloy
Current Rating : 200A @ 5 Min
Current Rating – Intermittent : 500A
Handle : Zinc Alloy
Body : Thermoset Polyester
Weight : 3.8kg
Approvals : AS3947.3.2001, C-Tick
Ingress Protection : IP66

Delayed Switching – Manual vs Electrical

A unique feature of the Big Red battery isolator is delayed switching of the auxiliary contacts. The delay is different when being electrically switched vs manually switched.

Electrically Switched:

Approximately 2-3 milliseconds prior to the main contacts opening.

Manually Switched:

100-150 millisecond prior to the main contacts opening.

For full details on the iROS Rollover Switch see page 16.

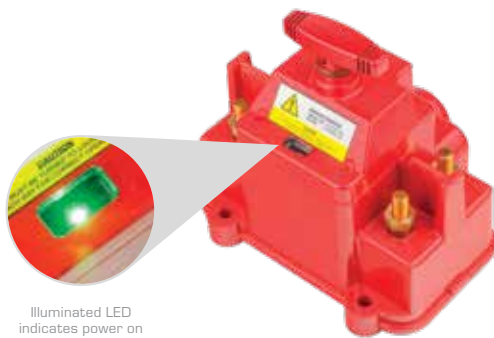

Illuminated LED indicates power on

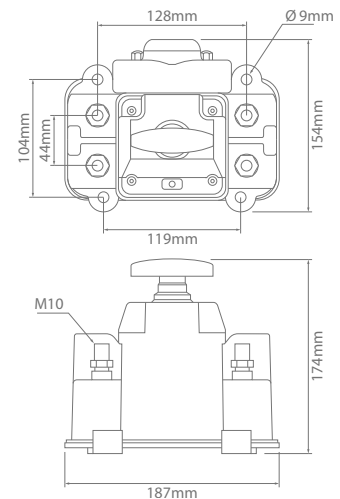

Big Red

| Part No. | Voltage | Description |
|----------|---------|--|
| SSB100 | 24 | Battery Isolator for use with AS2809.2 compliant rollover switch |
| SSB102 | 12 | Battery Isolator for use with AS2809.2 compliant rollover switch |

For full details of the iROS Rollover Switch see page 16.

BMS - Remote Switching

- Remotely activated battery master switch.
- Silver alloy contacts.
- Environmentally sealed – IP65.
- Double Pole models supplied with terminal insulators.
- Single Pole models supplied with DIN connector.
- Auxiliary output with Single Pole models.



BMS-14



BMS-32

IP65

Contacts : Silver Alloy
 Body : Polymer
 Ingress Protection : IP65

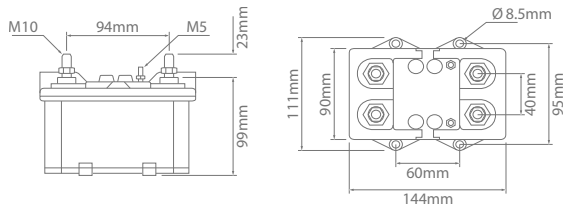

Remote Switching – Double Pole

| Part No. | Voltage | Description | Contacts (A) | | Coil (A) | |
|---------------|---------|-------------|--------------|------------|----------|------------|
| | | | Intermittent | Continuous | Inrush | Continuous |
| BMS-14 | 24 | Double Pole | 2500 | 250 | 3.4 | 0.3 |

Supplied with terminal insulators.

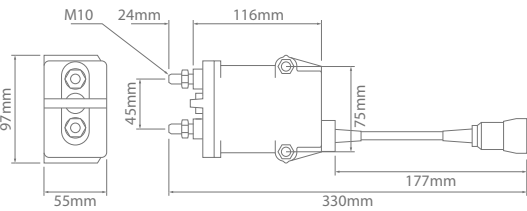

Remote Switching – Single Pole

| Part No. | Voltage | Description | Main Contacts (A) | | Auxiliary Contacts (A) | Coil (A) | |
|---------------|---------|----------------------------|-------------------|------------|------------------------|----------|------------|
| | | | Intermittent | Continuous | Continuous | Inrush | Continuous |
| BMS-32 | 12 | Single Pole with Auxiliary | 2500 | 250 | 2 | 13.5 | 0.025 |
| BMS-34 | 24 | Single Pole with Auxiliary | 2500 | 250 | 2 | 8.5 | 0.025 |

Supplied with DIN connector.



BMS - Kits

Battery Lockout Kits

NEW



MS-HL03/16

- Kits to suit popular mine site vehicles.
- Install with minimal engine bay modification.
- Models incorporate both a battery isolator and starter isolator.
- 175A 'Jump Start Receptacle'.
- Pre-assembled.
- Switches clearly labelled.
- Powder coated brackets.
- Manufactured in Australia.

| | |
|-----------------------------|-------------------------|
| Brackets : | Powder Coated Aluminium |
| Wire Size : | 35mm ² |
| Main Contacts : | Intermittent 1000A |
| | Continuous 125A |
| Auxiliary Contacts : | Continuous 20A |



175A 'Jump Start Receptacle'



MS-PD03/18



MS-LC03/18

Easy Installation

Manufactured in Australia the IONNIC range of battery lockout kits are pre-assembled and designed to be installed with minimal need for drilling or other engine bay modifications. Kits to suit the popular vehicles used on mine sites are available in multiple configurations all with jump start receptacles.

High quality components are used in their construction and the attention to detail extends to the use of terminal insulators and conduit clips to ensure the harness protection will always remain in place.





MS-HL03/16



MS-LC03/18



MS-PD03/18

Battery Lockout Kits – Toyota NEW

| Part No. | Suits |
|-------------------|---|
| MS-HL03/16 | Hi-Lux – Mid 2016 on (diesel) |
| MS-LC03/18 | Landcruiser – 70 Series V8 2018 On (diesel) |
| MS-PD03/18 | Prado 2018 On |



BMS - Kits

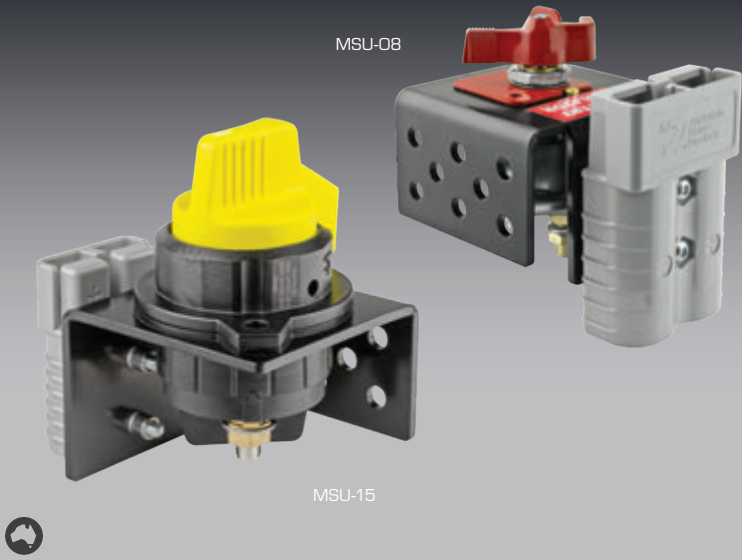

- Now available with BMS-001/BMS-002.
- BMS-17 features auxiliary contacts.
- Compact size.
- Suitable for use on any vehicle.
- Kits to suit battery or starter isolation.
- Available with either a 175A or 350A 'Jump Start Receptacle'.
- Powder coated brackets.
- Manufactured in Australia.

Bracket : Powder Coated Aluminium

For specs on the BMS-001, BMS-002 and BMS-17 see page 28-29.



Universal Lockout Kits – 175A Jump Start – BMS-17

| Part No. | Label | Kits Contain: |
|---------------|--------------------|---|
| MSU-04 | "BATTERY ISOLATOR" | 1 x Universal mounting bracket |
| MSU-05 | "STARTER ISOLATOR" | 1 x 175A High current connector |
| | | 1 x Single Pole fixed handle battery master switch BMS-17 |
| | | 1 x Two piece metal lockout bracket Red or Yellow |
| | | 1 x Label "BATTERY ISOLATOR" or "STARTER ISOLATOR" |
| | | 2 x 30mm button-head M6 bolt |

Supplied in component form.



Universal Lockout Kits – 350A Jump Start – BMS-17

| Part No. | Label | Kits Contain: |
|---------------|--------------------|---|
| MSU-08 | "BATTERY ISOLATOR" | 1 x Universal mounting bracket |
| MSU-09 | "STARTER ISOLATOR" | 1 x 350A High current connector |
| | | 1 x Single Pole fixed handle battery master switch BMS-17 |
| | | 1 x Two piece metal lockout bracket Red or Yellow |
| | | 1 x Label "BATTERY ISOLATOR" or "STARTER ISOLATOR" |
| | | 2 x 40mm button-head M6 bolt |

Supplied in component form.

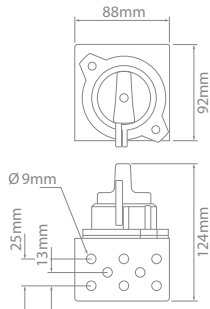

STARTER ISOLATOR
OR
BATTERY ISOLATOR

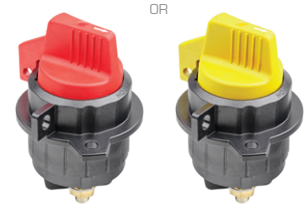

BMS-001

BMS-002

Universal Lockout Kits – BMS-001/BMS-002 NEW

| Part No. | Label |
|---------------|--------------------|
| MSU-01 | "BATTERY ISOLATOR" |
| MSU-02 | "STARTER ISOLATOR" |

Kits Contain:
 1 x Universal mounting bracket
 1 x Single pole fixed handle battery master switch **BMS-001** or **BMS-002**
 1 x Label "BATTERY ISOLATOR" or "STARTER ISOLATOR"
 1 x Gasket

Supplied in component form.

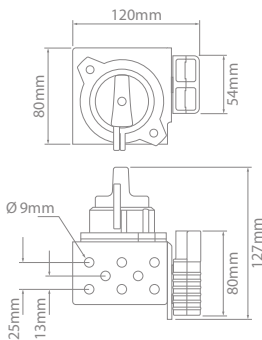

STARTER ISOLATOR
OR
BATTERY ISOLATOR



BMS-001

BMS-002

Universal Lockout Kits – 175A Jump Start – BMS-001/BMS-002 NEW

| Part No. | Label |
|---------------|--------------------|
| MSU-14 | "BATTERY ISOLATOR" |
| MSU-15 | "STARTER ISOLATOR" |

Kits Contain:
 1 x Universal mounting bracket
 1 x 175A High current connector
 1 x Single pole fixed handle battery master switch **BMS-001** or **BMS-002**
 1 x Label "BATTERY ISOLATOR" or "STARTER ISOLATOR"
 2 x 30mm button-head M6 bolt
 1 x Gasket

Supplied in component form.

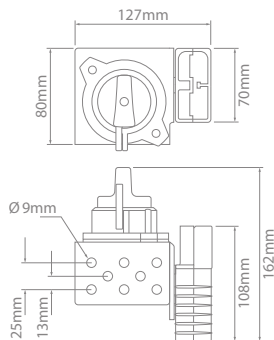

STARTER ISOLATOR
OR
BATTERY ISOLATOR



BMS-001

BMS-002

Universal Lockout Kits – 350A Jump Start – BMS-001/BMS-002 NEW

| Part No. | Label |
|---------------|--------------------|
| MSU-18 | "BATTERY ISOLATOR" |
| MSU-19 | "STARTER ISOLATOR" |

Kits Contain:
 1 x Universal mounting bracket
 1 x 350A High current connector
 1 x Single pole fixed handle battery master switch **BMS-001** or **BMS-002**
 1 x Label "BATTERY ISOLATOR" or "STARTER ISOLATOR"
 2 x 40mm button-head M6 bolt
 1 x Gasket

Supplied in component form.



BMS - Accessories

Terminal Insulators



- Protects terminals from electrical shorts and shocks.
- Colour coded for easy identification.
- Wide range of sizes & styles available.
- 200 Series feature finger tab for easy removal.
- Bulk packs available.

Material :
Max. Operating Temperature :
Burning Behaviour :

Flexible PVC
 105°C
 UL94V2

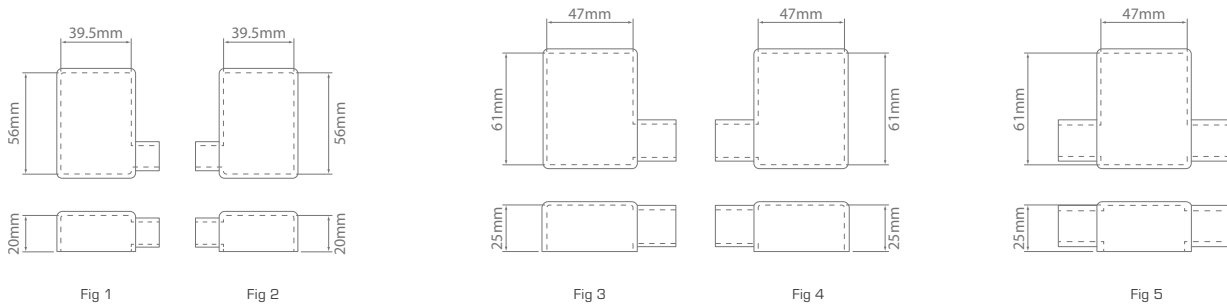

SY2906-RED
(Right hand)



SY2914-BLK
(Left hand)



SY2915-RED
(Double)

Battery Terminal Insulators

| Red | Black | Pack Qty | Post Height (mm) | Cable Ø (mm) | Cable Entry | Material Thickness (mm) | Fig |
|--------------------|--------------------|----------|------------------|--------------|-------------|-------------------------|-----|
| SY2906-RED | SY2906-BLK | 1 | 20 | 12.5 | Right Hand | 1.5 | 1 |
| SY2906R/100 | SY2906B/100 | 100 | | | | | |
| SY2910-RED | SY2910-BLK | 1 | 20 | 12.5 | Left Hand | 1.5 | 2 |
| SY2910R/100 | SY2910B/100 | 100 | | | | | |
| SY2912-RED | SY2912-BLK | 1 | 25 | 17.5 | Right Hand | 2.3 | 3 |
| SY2912R/100 | SY2912B/100 | 100 | | | | | |
| SY2914-RED | SY2914-BLK | 1 | 25 | 17.5 | Left Hand | 2.3 | 4 |
| SY2914R/100 | SY2914B/100 | 100 | | | | | |
| SY2915-RED | SY2915-BLK | 1 | 25 | 17.5 | Double | 2.3 | 5 |
| SY2915R/100 | SY2915B/100 | 100 | | | | | |

BMS - Accessories

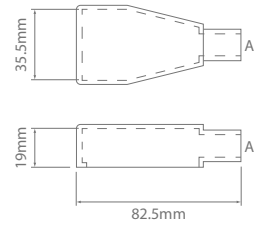

Battery Terminal Insulators – Straight Leads

| Red | Black | Pack Qty | Post Height (mm) | Cable Ø A (mm) | Material Thickness (mm) |
|--------------------|--------------------|----------|------------------|----------------|-------------------------|
| SY2917-RED | SY2917-BLK | 1 | 19 | 12.5 | 2.3 |
| SY2917R/100 | SY2917B/100 | 100 | | | |
| SY2919-RED | SY2919-BLK | 1 | 19 | 16 | 2.3 |
| SY2919R/100 | SY2919B/100 | 100 | | | |

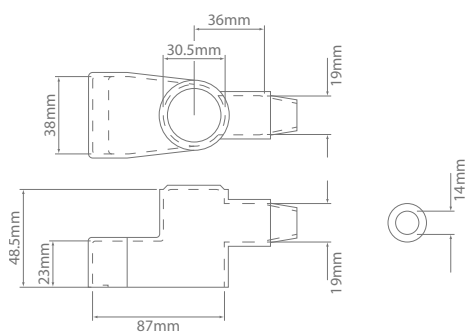

SY2990

Fig 1

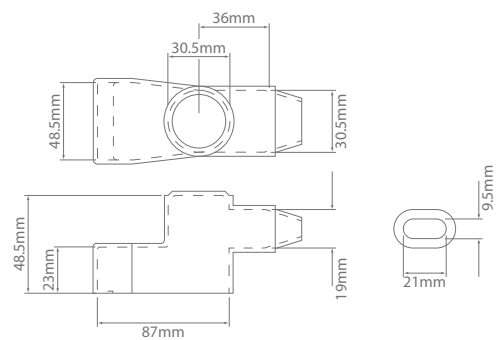

SY2995

Fig 2

Battery Terminal Insulators

| Red | Black | Pack Qty | Terminal Ø (mm) | Post Height (mm) | Material Thickness (mm) | Fig |
|--------------------|--------------------|----------|-----------------|------------------|-------------------------|-----|
| SY2990-RED | SY2990-BLK | 1 | 30.5 | 23 | 2 | 1 |
| SY2990R/100 | SY2990B/100 | 100 | | | | |
| SY2995-RED | SY2995-BLK | 1 | 30.5 | 23 | 2 | 2 |
| SY2995R/100 | SY2995B/100 | 100 | | | | |



BMS - Accessories



SY2900

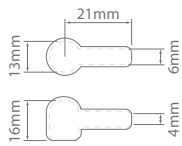

SY2980

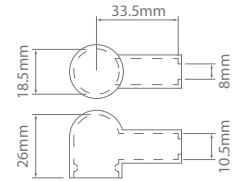

SY2982

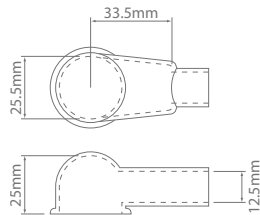

SY2984

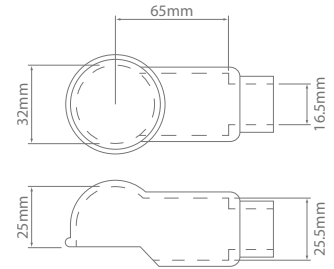

Terminal Insulators – Lug & Ring

| Red | Black | Pack Qty | Terminal Ø (mm) | Post Height (mm) | Terminal Length (mm) | Inside Grip (mm) | Cable Ø (mm) | Material Thickness (mm) |
|--------------------|--------------------|----------|-----------------|------------------|----------------------|------------------|--------------|-------------------------|
| SY2900-RED | SY2900-BLK | 1 | 13 | 16 | 21 | 6 | 4-6 | 1 |
| SY2900R/100 | SY2900B/100 | 100 | | | | | | |
| SY2980-RED | SY2980-BLK | 1 | 18.5 | 26 | 33.5 | 10.5 | 8 | 1.5 |
| SY2980R/100 | SY2980B/100 | 100 | | | | | | |
| SY2982-RED | SY2982-BLK | 1 | 25.5 | 25 | 33.5 | 12.5 | 12.5 | 1.5 |
| SY2982R/100 | SY2982B/100 | 100 | | | | | | |
| SY2984-RED | SY2984-BLK | 1 | 32 | 25 | 65 | 25.5 | 16.5 | 2.5 |
| SY2984R/100 | SY2984B/100 | 100 | | | | | | |

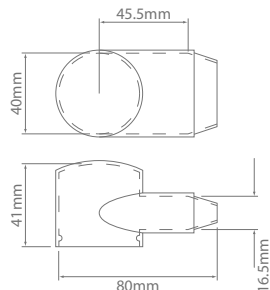

SY2999-RED



SY2998-RED

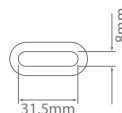

SY2998-RED

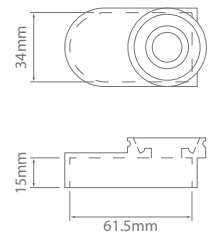

Terminal Insulators – Lug & Ring – Marine

| Red | Black | Pack Qty | Terminal Ø (mm) | Post Height (mm) | Terminal Length (mm) | Material Thickness (mm) |
|--------------------|--------------------|----------|--------------------------|------------------|----------------------|-------------------------|
| SY2999-RED | SY2999-BLK | 1 | 40 | 41 | 58.5 | 1.5 |
| SY2999R/100 | SY2999B/100 | 100 | | | | |
| SY2998-RED | SY2998-BLK | 1 | Base for use with SY2999 | | | 2.5 |

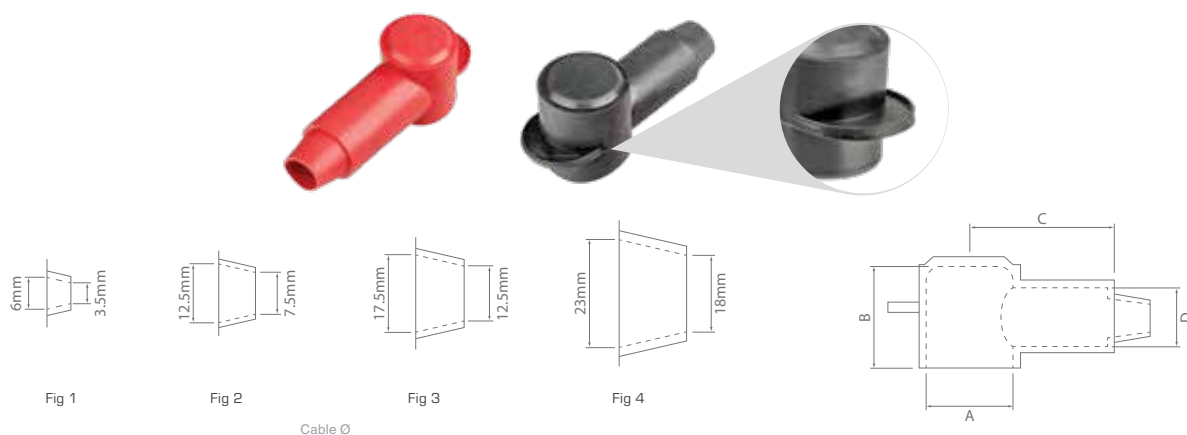

Terminal Insulators – Lug & Ring – 200 Series

| Red | Black | Pack Qty | Terminal Ø A (mm) | Post Height B (mm) | Terminal Length C (mm) | Inside Grip D (mm) | Cable Ø Fig | Material Thickness (mm) |
|--------------------|--------------------|----------|-------------------|--------------------|------------------------|--------------------|-------------|-------------------------|
| SY2959-RED | SY2959-BLK | 1 | 12 | 18 | 25.5 | 12.5 | 1 | 1.5 |
| SY2959R/100 | SY2959B/100 | 100 | | | | | | |
| SY2960-RED | SY2960-BLK | 1 | 14 | 19 | 25.5 | 12.5 | 1 | 1.5 |
| SY2960R/100 | SY2960B/100 | 100 | | | | | | |
| SY2963-RED | SY2963-BLK | 1 | 16 | 20.5 | 25.5 | 12.5 | 2 | 1.5 |
| SY2963R/100 | SY2963B/100 | 100 | | | | | | |
| SY2965-RED | SY2965-BLK | 1 | 18 | 22 | 25.5 | 12.5 | 2 | 1.5 |
| SY2965R/100 | SY2965B/100 | 100 | | | | | | |
| SY2966-RED | SY2966-BLK | 1 | 20 | 24 | 33.5 | 18 | 3 | 1.8 |
| SY2966R/100 | SY2966B/100 | 100 | | | | | | |
| SY2968-RED | SY2968-BLK | 1 | 22 | 26.5 | 44.5 | 19 | 3 | 1.8 |
| SY2968R/100 | SY2968B/100 | 100 | | | | | | |
| SY2971-RED | SY2971-BLK | 1 | 26 | 32 | 52.5 | 18 | 3 | 2 |
| SY2971R/100 | SY2971B/100 | 100 | | | | | | |
| SY2970-RED | SY2970-BLK | 1 | 28 | 33.5 | 44.5 | 19 | 3 | 2.3 |
| SY2970R/100 | SY2970B/100 | 100 | | | | | | |
| SY2973-RED | SY2973-BLK | 1 | 32 | 38 | 44.5 | 23 | 3 | 2.5 |
| SY2973R/100 | SY2973B/100 | 100 | | | | | | |
| SY2974-RED | SY2974-BLK | 1 | 32 | 38 | 60.5 | 23 | 3 | 2.5 |
| SY2974R/100 | SY2974B/100 | 100 | | | | | | |
| SY2975-RED | SY2975-BLK | 1 | 32 | 38 | 44.5 | 23 | 4 | 2.5 |
| SY2975R/100 | SY2975B/100 | 100 | | | | | | |



Extension Stud

| Part No. | Description |
|--|-------------------------------------|
| BMS-ES | M10 brass extension stud – 60mm |
| BMS-IMP  | 3/8"-24 brass extension stud – 60mm |

